

SIO
Valves & Automation



S426

**Wafer Type Butterfly
Valve PTFE Seated
with SS304 Disc**



DESIGN FEATURES

- Wafer design
- Valve Design According to API609
- Face to face according to API609
- Actuator mounting plate according to ISO 5211
- Epoxy painted
- Resilient seat
- Bidirectional sealing
- Lever handle with 10 position locking system
- Maximum working pressure 10 bar
- Double "D" style stem
- End allows installation between ANSI 150, EN 1092-2 PN 10/16 and JIS B2220 10K flanges.
- Working Temperature -29°C +140 °C.
- Body in Ductile Iron A536 65-45-12
- Disc made of Stainless Steel CF8
- PTFE body seat

Material List & Dimensions 2"~12"

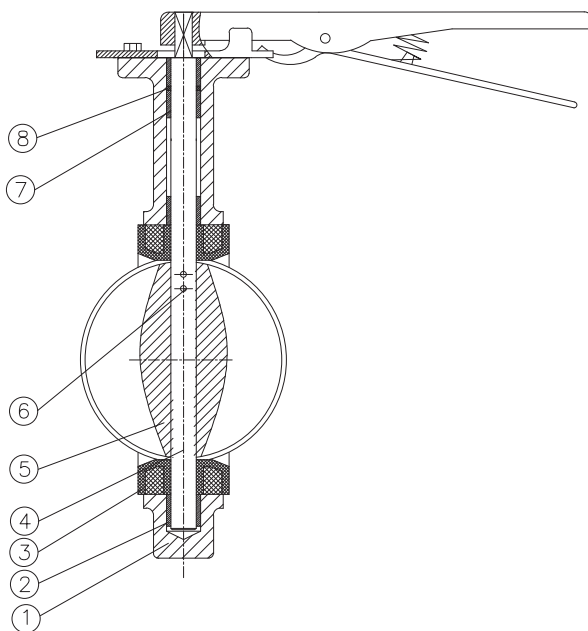

Material List

No	Part Name	Material
1	Body	ASTM A-536 Gr. 65-45-12
2	Long Busing	FRP
3	Seat	PTFE
4	Stem	ASTM A-276 Gr. 410
5	Disc	ASTM A-351 Gr. CF8
6	Pin	SS304
7	Short Busing	FRP
8	O-ring	NBR

Dimensions and Weight 2"-12" Lever Operated

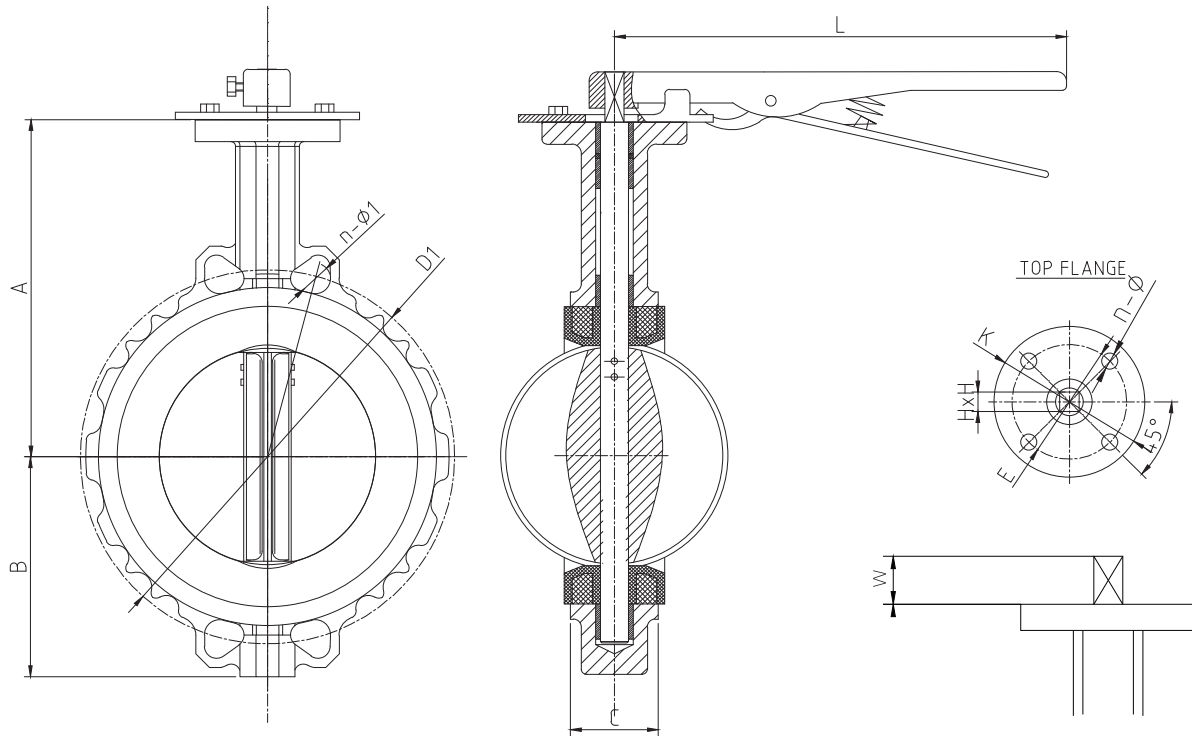

Dimensions (mm) & Weight(Kgs)

Item	Size	A	B	C	D1	N- Φ	L	ISO 5211	K	E	N	H*H	w	Weight
S426L 09	2"	140	80	43	120.7	4-19	260	F05	65	50	4-7	11*11	14	3.1
S426L 10	2 1/2"	150	89	46	139.70	4-19	260	F05	65	50	4-7	11*11	14	3.4
S426L 11	3"	158	95	46	152.4	4-19	260	F05	65	50	4-7	11*11	14	3.8
S426L 12	4"	176	114	52	190.5	8-19	260	F05	65	50	4-7	11*11	14	5.2
S426L 13	5"	190	127	56	215.9	8-23	260	F07	90	70	4-10	14*14	17	7
S426L 14	6"	212	139	56	241.3	8-23	260	F07	90	70	4-10	14*14	17	8.7
S426L 15	8"	236	174	60	298.50	8-23	360	F10	125	102	4-12	17*17	22	14.5
S426L 16	10"	265	203	68	362	12-26	360	F10	125	102	4-12	22*22	22	20.5
S426L 17	12"	305	242	78	431.8	12-26	360	F10	125	102	4-12	22*22	22	30.3

Standard Operation for 2" to 12" is Lever handle with 10 position locking system

Dimensions and Weight 2"-12" Gear Operated

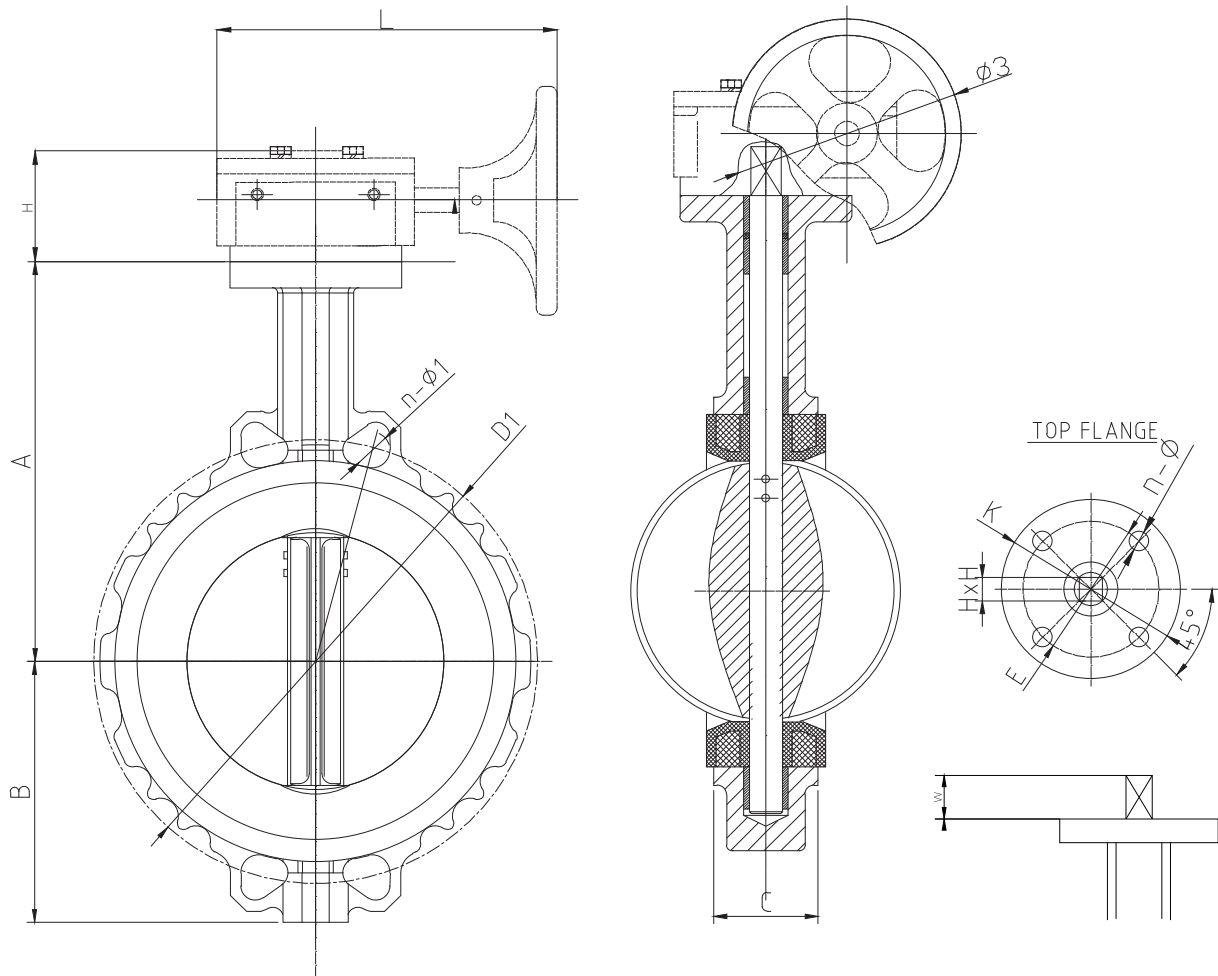

Dimensions (mm) & Weight(Kgs)

Item	Size	A	B	C	D1	N- Φ	H1	L	Φ3	ISO 5211	K	E	ΦN	H*H	w	Weight
S426G 09	2"	140	80	43	120.7	4-19	71	205	147	F05	65	50	4-7	11*11	14	5.8
S426G 10	2 1/2"	150	89	46	139.70	4-19	71	205	147	F05	65	50	4-7	11*11	14	6.1
S426G 11	3"	158	95	46	152.4	4-19	71	205	147	F05	65	50	4-7	11*11	14	6.5
S426G 12	4"	176	114	52	190.5	8-19	71	205	147	F05	65	50	4-7	11*11	14	7.9
S426G 13	5"	190	127	56	215.9	8-23	71	205	147	F07	90	70	4-10	14*14	17	9.7
S426G 14	6"	212	139	56	241.3	8-23	71	205	147	F07	90	70	4-10	14*14	17	11.4
S426G 15	8"	236	174	60	298.50	8-23	82	290	292	F10	125	102	4-12	17*17	22	20.5
S426G 16	10"	265	203	68	362	12-26	82	290	292	F10	125	102	4-12	22*22	22	26.5
S426G 17	12"	305	242	78	431.8	12-26	82	295	292	F10	125	102	4-12	22*22	22	37.8

Gear Operation is only available upon request.

Material List & Dimensions 14"

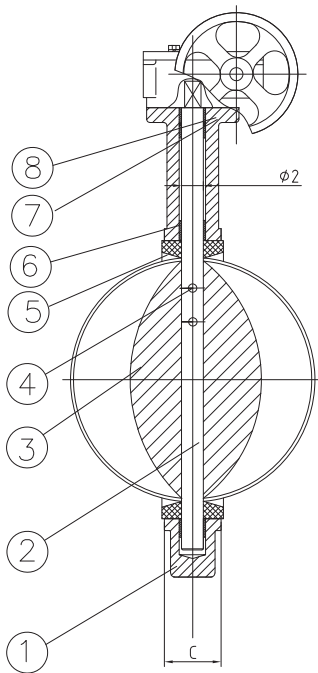
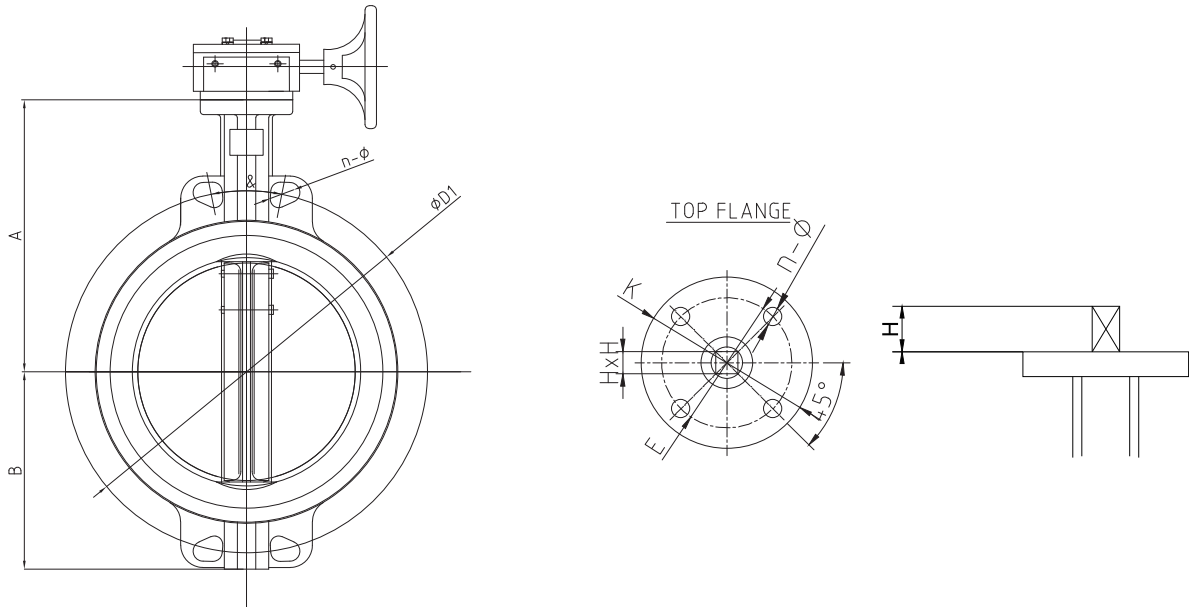

Material List

No	Part Name	Material
1	Body	ASTM A-536 Gr. 65-45-12
2	Stem	ASTM A-276 Gr. 410
3	Disc	ASTM A-351 Gr. CF8
4	Pin	SS304
5	Seat	PTFE
6	Long Busing	FRP
7	O-ring	NBR
8	Short Busing	FRP

Dimensions (mm) & Weight(Kgs)

Item	Size	A	B	C	D1	N- φ	ISO 5211	K	E	φ N	H*H	w	Weight
S426G 18	14"	368	267	78	476.30	12-29	F10	125	102	4-12	22*22	22	45.8

Gear Operation is standard for 14"

Material List & Dimensions 16" & large

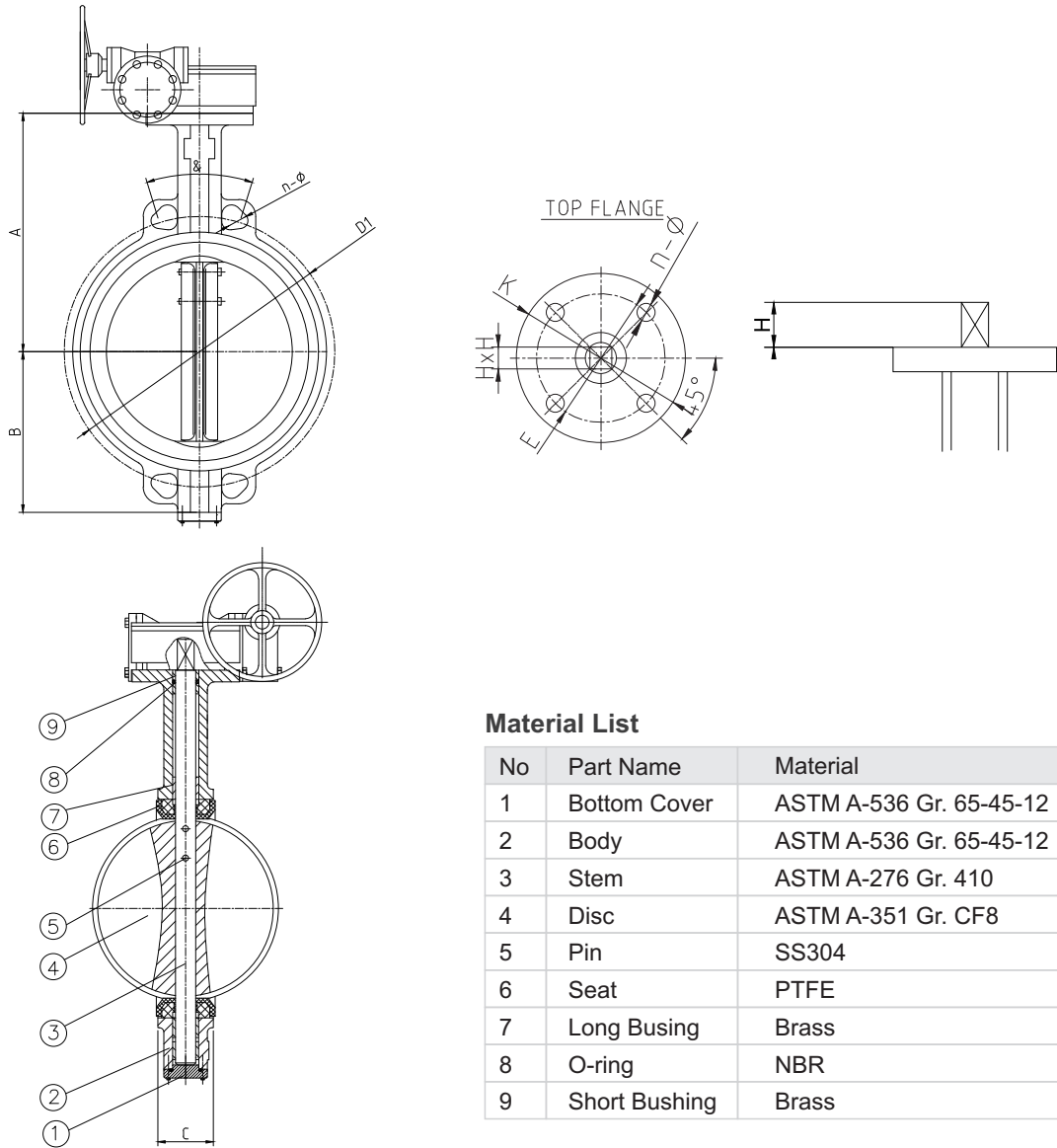

Material List

No	Part Name	Material
1	Bottom Cover	ASTM A-536 Gr. 65-45-12
2	Body	ASTM A-536 Gr. 65-45-12
3	Stem	ASTM A-276 Gr. 410
4	Disc	ASTM A-351 Gr. CF8
5	Pin	SS304
6	Seat	PTFE
7	Long Busing	Brass
8	O-ring	NBR
9	Short Busing	Brass

Dimensions (mm) & Weight(Kgs)

Item	Size	A	B	C	D1	N- Φ	ISO 5211	K	E	Φ N	H*H	w	Weight(KGS)
S426G 19	16"	400	309	102	539.80	16-29	F14	175	140	4-18	27*27	36	89.3
S426G 20	18"	422	340	114	577.90	16-32	F14	175	140	4-18	27*27	36	102.5
S426G 21	20"	440	362	127	635	20-32	F14	175	140	4-18	36*36	36	127.3
S426G 22	24"	565	452	154	749.30	20-35	F16	210	165	4-22	36*36	46	234.5

Gear Operation is standard for 16" & large
Please ask SIO team for more sizes.

Dimensions (mm) & Weight(Kgs)

Size	Disc Position (degrees)								
	90°	80°	70°	60°	50°	40°	30°	20°	10°
2"	125	99	73	53	37	23	14	6	0,9
2 1/2"	244	193	141	93	58	37	21	10	1,3
3"	399	315	231	133	83	53	30	13	1,7
4"	727	606	429	237	148	94	54	23	2,6
5"	1190	991	670	370	232	147	85	37	4
6"	1600	1334	887	490	306	195	112	48	5
8"	2868	2458	1611	935	588	364	208	88	10
10"	4697	3914	2550	1479	931	577	330	140	16
12"	6987	5822	3800	2217	1379	869	480	203	23
14"	9115	7676	5137	2927	1859	1142	654	259	29
16"	12081	10173	6805	3878	2463	1513	866	343	39
18"	14890	12539	8706	4962	3151	1935	1108	439	50
20"	19323	16272	10843	6180	3924	2410	1380	547	62
24"	37295	33939	22626	14297	8640	4848	2238	1057	130

Kv VALUES

Kv = Flow rate of water in cubic meter per hour (m3/h) that will generate a pressure drop of 1 bar across the valve.

Cv VALUES

Cv = Flow rate of water (g.p.m.) which generates a pressure drop of 1 psi across the valve

$Cv = 1,156 \cdot Kv$

Torque without safety factor

Size	Torque(Nm) @ working pressure	
	0.6Mpa	1.0Mpa
1 1/2"	10	13
2"	12	14
2 1/2"	20	23
3"	29	33
4"	51	56
5"	78	87
6"	122	143
8"	215	261
10"	329	403
12"	458	615
14"		793
16"		1157
18"		1612
20"		2171
24"		3328
28"		4836
32"		7332
36"		9945
40"		12740
48"		21840



SIO
Valves & Automation

Authorized distributor

IMPORTANT NOTICE

- Data listed in the catalog, including dimensions, weights, specifications and other valve related data are intended to provide general information and guidance only.
- SIO valve assumes no responsibility for errors or inadequacy relevant to any information provided in this catalog. Any information provided in this catalog is subject to change without notice.
- SIO Valve reserves the right to change designs, materials, or specifications without notice or without obligation to furnish or install such changes on products previously or subsequently sold.